

Autodesk  
**AutoCAD Architecture 2008**  
**Fundamentals**

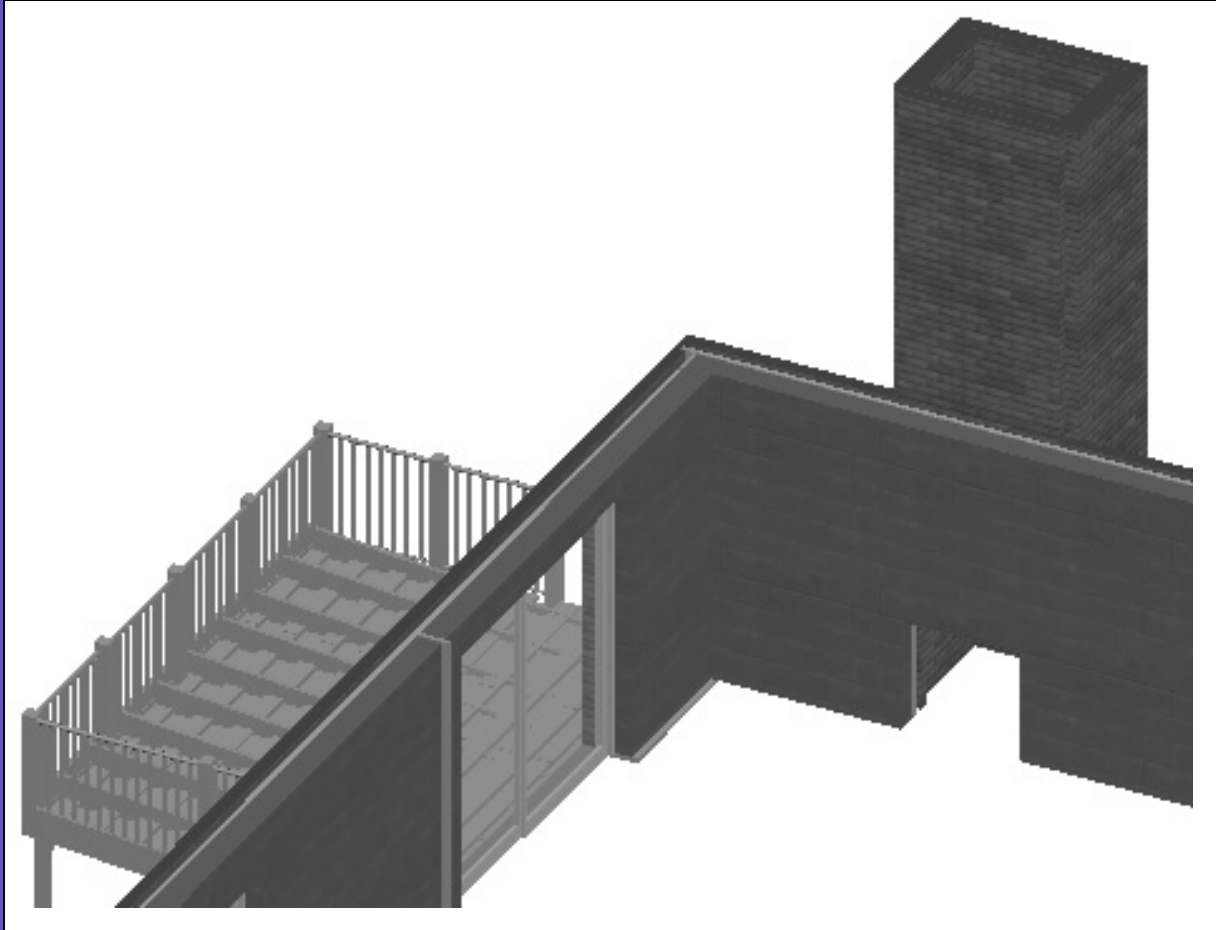

**Elise Moss**

**SDC**  
PUBLICATIONS

Schroff Development Corporation

---

[www.schroff.com](http://www.schroff.com)  
[www.schroff-europe.com](http://www.schroff-europe.com)

# TABLE OF CONTENTS

## Preface

## Acknowledgements

## Lesson 1

### Desktop Features

Exercise 1-1: Setting the Template for QNEW	1-5
Exercise 1-2: Creating a New Drawing with an AEC Template	1-7
Exercise 1-3: Creating a New Geometric Profile	1-25
Exercise 1-4: Creating a New Visual Style	1-30
Exercise 1-5: Creating a New Wall Style	1-32
Exercise 1-6: Creating a Tool	1-42
Exercise 1-7: Copying a Style to a Template	1-45
Exercise 1-8: Downloading Styles from Autodesk's Website	1-48
Exercise 1-9: Exploring the Display Manager	1-56

## Lesson 2

### Site Plans

Exercise 2-1: Installing the Express Tools	2-2
Exercise 2-2: Creating Custom Line Types	2-3
Exercise 2-3: Creating a Custom Text Style	2-6
Exercise 2-4: Creating New Layers	2-7
Exercise 2-5: Transferring a Toolbar	2-11
Exercise 2-6: Creating a Site Plan	2-12
Exercise 2-7: Creating a Layer User Group	2-22

<b>Quiz 1</b>	Q1-1
---------------	------

**Lesson 3****Floor Plans**

Exercise 3-1: Creating Exterior Walls	3-1
Exercise 3-2: Convert to Walls	3-3
Exercise 3-3: Wall Cleanup	3-7
Exercise 3-4: Adding Closet Doors	3-14
Exercise 3-5: Adding Interior Doors	3-17
Exercise 3-6: Add Opening	3-18
Exercise 3-7: Adding Doors	3-23
Exercise 3-8: Add Window Assemblies	3-28
Exercise 3-9: Adding a Fireplace	3-33

<b>Quiz 2</b>	Q2-1
---------------	------

**Lesson 4****Space Planning**

Exercise 4-1: Creating AEC Content	4-1
Exercise 4-2: Equipping the Bathrooms	4-6
Exercise 4-3: Changing the Icons on a Tool Palette	4-9
Exercise 4-4: Furnishing the Common Areas	4-11
Exercise 4-5: Adding to the Service Areas	4-17

**Lesson 5****Roofs**

Exercise 5-1: Creating a Roof using Existing Walls	5-4
Exercise 5-2: Roof Slabs	5-5
Exercise 5-3: Creating a Roof Cricket	5-7

<b>Quiz 3</b>	Q3-1
---------------	------

**Lesson 6****Structural Members**

Exercise 6-1: Creating Member Styles	6-4
Exercise 6-2: Adding Structural Members	6-6
Exercise 6-3: Miter Corners	6-13
Exercise 6-4: Add Floorboards	6-14
Exercise 6-5: Add Railing	6-17
Exercise 6-6: Add Stairs	6-23

**Lesson 7****Layouts**

Exercise 7-1: Creating a Custom Toolbar	7-2
Exercise 7-2: Creating an Elevation Label	7-3
Exercise 7-3: Creating an Elevation Window Tag	7-10
Exercise 7-4: Creating a Custom Titleblock	7-18
Exercise 7-5: Creating a Drawing Template	7-28
Exercise 7-6: Creating a Keynote Database	7-35
Exercise 7-7: Adding a Keynote Database to a Project	7-41
Exercise 7-8: Creating a Sheet Set	7-44
Exercise 7-9: Creating Elevation Views	7-51
Exercise 7-10: Changing Hatch Patterns in an Elevation View	7-54
Exercise 7-11: Creating an Elevation Sheet	7-57
Exercise 7-12: Adding Keynotes to a Sheet	7-61
Exercise 7-13: Adding Elevation Labels to a Sheet	7-67

**Quiz 4**

Q4-1

**Lesson 8**

**Dimensioning**

Exercise 8-1: Dimensioning a Floor Plan	8-3
--	-----

**Lesson 9**

**Schedules**

Exercise 9-1: Creating a Schedule Table	9-8
Exercise 9-2: Adding Window Tags	9-13
Exercise 9-3: Adding Door Tags	9-14
Exercise 9-4: Adding a Schedule Table	9-16
Exercise 9-5: Exporting a Schedule	9-19

**Lesson 10**

**Creating a Video**

Exercise 10-1: Adding a Path	10-1
Exercise 10-2: Using the Camera Tool	10-3
Exercise 10-3: Creating a Video	10-6

<b>Comprehensive Exam</b>	E-1
---------------------------	-----

**About the Author**