

Design Integration Using Autodesk Revit® 2010

✦ **Architecture, Structural and MEP** ✦

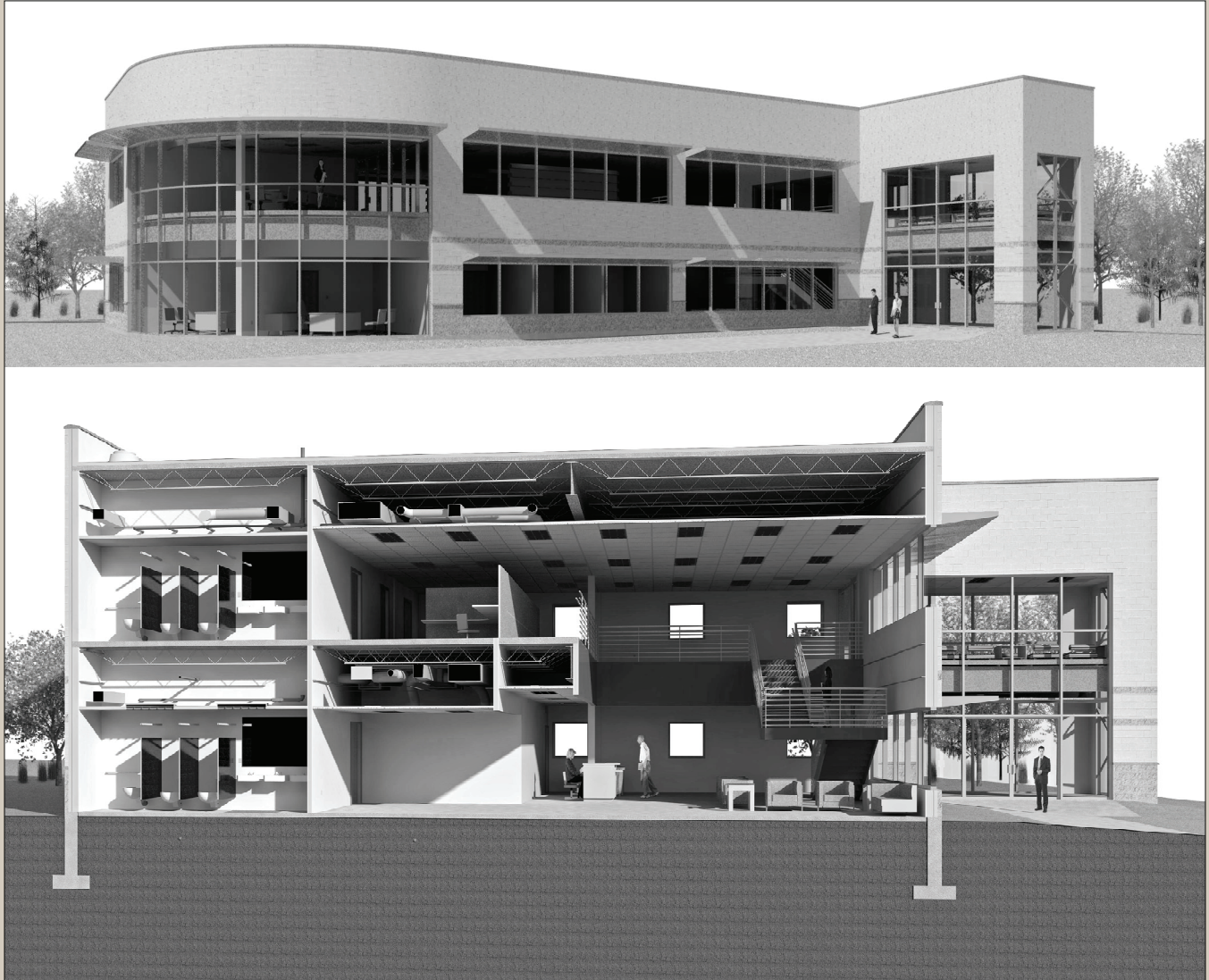

Daniel John Stine CSI, CDT

SDC
PUBLICATIONS

Schroff Development Corporation
www.SDCpublications.com

Better Textbooks. Lower Prices.

INSIDE:

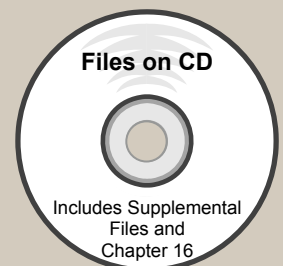

Table of Contents

1.	Introduction to Computers for CAD/BIM Users	
1-1	Computer Basics: Terms and Functions	1-1
1-2	Overview of the Windows User Interface	1-19
1-3	File Management Introduction	1-29
1-4	File Management Exercises	1-46
	<i>Self-Exam & Review Questions</i>	1-48
2.	Getting Started with Revit Architecture 2010	
2-1	What Is Revit Architecture 2010	2-1
2-2	Overview of the Revit User Interface	2-10
2-3	Open, Save and Close and Existing Project	2-20
2-4	Creating a New Project	2-25
2-5	Using Pan and Zoom to View Your Drawings	2-27
2-6	Using Revit's Help System	2-32
	<i>Self-Exam & Review Questions</i>	2-35
3.	Quick Start: Small Office	
3-1	Walls, Grids and Dimensions	3-1
3-2	Doors	3-18
3-3	Windows	3-25
3-4	Roof	3-28
3-5	Annotation, Room Tags & Schedules	3-33
3-6	Printing	3-38
	<i>Self-Exam & Review Questions</i>	3-41
4.	Revit Basics: Overview of Linework and Modify Tools	
4-1	Lines and Shapes	4-1
4-2	Snap	4-16
4-3	Modify Tools	4-22
4-4	Annotations	4-35
	<i>Self-Exam & Review Questions</i>	4-39
5.	Revit Basics: Drawing 2D Architectural Content	
5-1	Sketching Rectilinear Objects	5-1
5-2	Sketching Objects With Curves	5-11
	<i>Self-Exam & Review Questions</i>	5-29
6.	Law Office: Floor Plans	
6-1	Project Overview	6-1
6-2	Exterior Walls	6-10
6-3	Interior Walls	6-24
6-4	Doors, Windows and Curtain Walls	6-40
6-5	Stairs	6-66
	<i>Self-Exam & Review Questions</i>	6-74
7.	Law Office: Roof, Floors & Ceilings	
7-1	Introduction to the Roof Tool	7-2
7-2	Law Office Roof	7-17
7-3	Floor Systems	7-25
7-4	Ceiling Systems	7-37
	<i>Self-Exam & Review Questions</i>	7-49

8.	Law Office: Structural System	
8-1	Introduction to Revit Structure	8-1
8-2	Creating Views and Loading Content	8-9
8-3	Grids, Columns and Beams	8-21
8-4	Floors and Bar Joist Layout	8-43
8-5	Foundations and Footings	8-57
8-6	Structural Annotation and Tags	8-70
	<i>Self-Exam & Review Questions</i>	8-78
9.	Law Office: Elevations, Sections and Details	
9-1	Exterior Elevations	9-1
9-2	Interior Elevations	9-12
9-3	Building Sections	9-17
9-4	Wall Sections	9-27
9-5	Linking AutoCAD Details	9-37
	<i>Self-Exam & Review Questions</i>	9-42
10.	Law Office: Interior Design	
10-1	Toilet Room Layouts	10-2
10-2	Cabinets	10-15
10-3	Furniture	10-24
10-4	Column Furring, Guardrails and Interior Curtain Wall	10-30
	<i>Self-Exam & Review Questions</i>	10-40
11.	Law Office: Schedules	
11-1	Rooms, Room Tags & Door Tags	11-1
11-2	Generate a Door Schedule	11-12
11-3	Generate a Room Finish Schedule	11-17
11-4	Creating a Graphical Column Schedule	11-25
	<i>Self-Exam & Review Questions</i>	11-28
12.	Law Office: Mechanical System	
12-1	Introduction to Revit MEP – Mechanical & Plumbing	12-1
12-2	Creating Views and Loading Content	12-8
12-3	Placing Air Terminals and the Air Handling Unit (AHU)	12-17
12-4	VAV Boxes, MEP Systems & Ductwork	12-26
12-5	Plumbing Layout	12-38
	<i>Self-Exam & Review Questions</i>	12-45
13.	Law Office: Electrical System	
13-1	Introduction to Revit MEP – Electrical	13-1
13-2	Creating Views and Loading Content	13-2
13-3	Panelboard, Power Devices and MEP Systems	13-6
13-4	Light Fixture and Light Switch Layout	13-18
13-5	Systems Layout	13-30
	<i>Self-Exam & Review Questions</i>	13-32
14.	Law Office: Site and Renderings	
14-1	Site Tools	14-1
14-2	Creating and Exterior Rendering	14-10
14-3	Rendering and Isometric Rendering	14-29
14-4	Creating and Interior Rendering	14-34
14-5	Adding People to the Rendering	14-34
	<i>Self-Exam & Review Questions</i>	14-37
15.	Law Office: Construction Documents Set	
15-1	Setting Up A Sheet	15-1
15-2	Sheet Index	15-12
15-3	Printing a Set of Drawings	15-16
	<i>Self-Exam & Review Questions</i>	15-19

CD Contents

16.	Revit Families: Introduction to Revit Content Creation	67 pages	
16-1	Basic Family Concepts		16-1
16-2	The Box: Creating the Geometry		16-13
16-3	The Box: Adding Parameters		16-29
16-4	The Box: Formulas and Materials		16-45
16-5	The Box: Family Types and Categories		16-59
	<i>Self-Exam & Review Questions</i>		16-67

Appendix A: Finding Missing Elements in Revit	22 pages	A-1
--	-----------------	------------

Roof Study Workbook – Draft Edition 89 pages

Resource Files required for successful completion of exercises in this book

