

Engineering Analysis with SolidWorks Simulation 2011

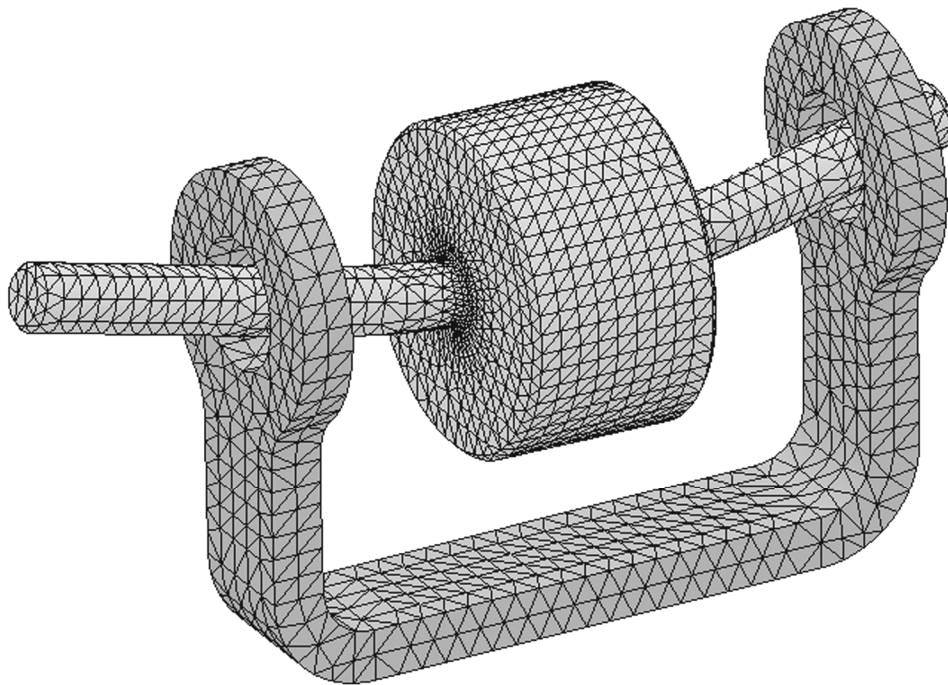

Paul M. Kurowski, Ph.D., P.Eng.



SDC
PUBLICATIONS

www.SDCpublications.com

Schroff Development Corporation



Design Generator, Inc.

Table of Contents

Before You Start	1
Notes on hands-on exercises and functionality of Simulation	
Prerequisites	
Selected terminology	
 1: Introduction	 5
What is Finite Element Analysis?	
Finite Element Analysis used by Design Engineers	
Objectives of FEA for Design Engineers	
What is SolidWorks Simulation?	
Fundamental steps in an FEA project	
Errors in FEA	
A closer look at finite elements	
What is calculated in FEA?	
How to interpret FEA results	
Units of measure	
Using online help	
Limitations of SolidWorks Simulation Professional	
 2: Static analysis of a plate	 31
Using the SolidWorks Simulation interface	
Linear static analysis with solid elements	
Finding reaction forces	
Controlling discretization errors with the convergence process	
Presenting FEA results in a desired format	
 3: Static analysis of an L-bracket	 75
Stress singularities	
Differences between modeling errors and discretization errors	
Using mesh controls	
Analysis in different SolidWorks configurations	
Nodal stresses, element stresses	

4: Static and frequency analyses of a pipe support	93
Use of shell elements	
Frequency analysis	
5: Static analysis of a link	111
Symmetry boundary conditions	
Preventing rigid body motions	
Limitations of the small displacement theory	
6: Frequency analysis of a tuning fork and a plastic part	121
Frequency analysis with and without supports	
Rigid body modes	
The role of supports in frequency analysis	
Symmetric and anti-symmetric modes	
7: Thermal analysis of a pipeline component and a heater	129
Analogies between structural and thermal analysis	
Steady state thermal analysis	
Analysis of temperature distribution and heat flux	
8: Thermal analysis of a heat sink	147
Analysis of an assembly	
Global and local Contact/Gap conditions	
Steady state thermal analysis	
Transient thermal analysis	
Thermal resistance layer	
Use of section views in result plots	
9: Static analysis of a hanger	163
Global and local Contact/Gap conditions	
Hierarchy of Contact/Gap conditions	

10: Analysis of contact stress	179
Global, Component and Local Contact conditions	
Assembly analysis with surface contact conditions	
Contact stress analysis	
Avoiding rigid body motions	
11: Thermal stress analysis of a bi-metal beam	189
Thermal stress analysis	
12: Buckling analysis of an I-beam	199
Buckling analysis	
Buckling load safety factor	
Stress safety factor	
13: Static analysis of a bracket using adaptive solution methods	207
h-adaptive solution method	
p-adaptive solution method	
Comparison between h-elements and p-elements	
14: Drop test	225
Drop test analysis	
Stress wave propagation	
Direct time integration solution	
15: Selected nonlinear problems	233
Large displacement analysis	
Membrane effects	
Following and non following load	
Nonlinear material analysis	
Residual stress	
16: Mixed meshing problem	275
Using solid and shell elements in the same mesh	
Mixed mesh compatibility	

17: Analysis of a weldment using beam elements	281
Different levels of idealization implemented in finite elements	
Preparation of a SolidWorks model for analysis with beam elements	
Beam elements and truss elements	
Analysis of results using beam elements	
Limitations of analysis with beam elements	
18: Review of 2D problems	307
Classification of finite elements	
2D axisymmetric element	
2D plane stress element	
2D plane strain element	
19: Vibration Analysis - Modal Time History and Harmonic	333
Modal Time History analysis (Time Response)	
Harmonic analysis (Frequency Response)	
Modal Superposition Method	
Damping	
20: Analysis of random vibration	361
Random vibration	
Power Spectral Density	
RMS results	
PSD results	
Modal excitation	
21: Miscellaneous topics	379
Mesh quality	
Solvers and solvers options	
Displaying mesh in result plots	
Automatic reports	
E drawings	
Non-uniform loads	
Bearing load	

Shrink fit analysis
Pin connector
Bolt connector
Weld connector
Remote load/mass
Circular symmetry

22: Implementation of FEA into the design process	425
Verification and Validation of FEA results	
FEA driven design process	
FEA project management	
FEA project checkpoints	
FEA reports	
23: Glossary of terms	443
24: Resources available to FEA users	451
25: List of exercises	455