

Residential Design Using Autodesk® Revit® Architecture 2013

Includes video instruction

Daniel John Stine CSI, CDT

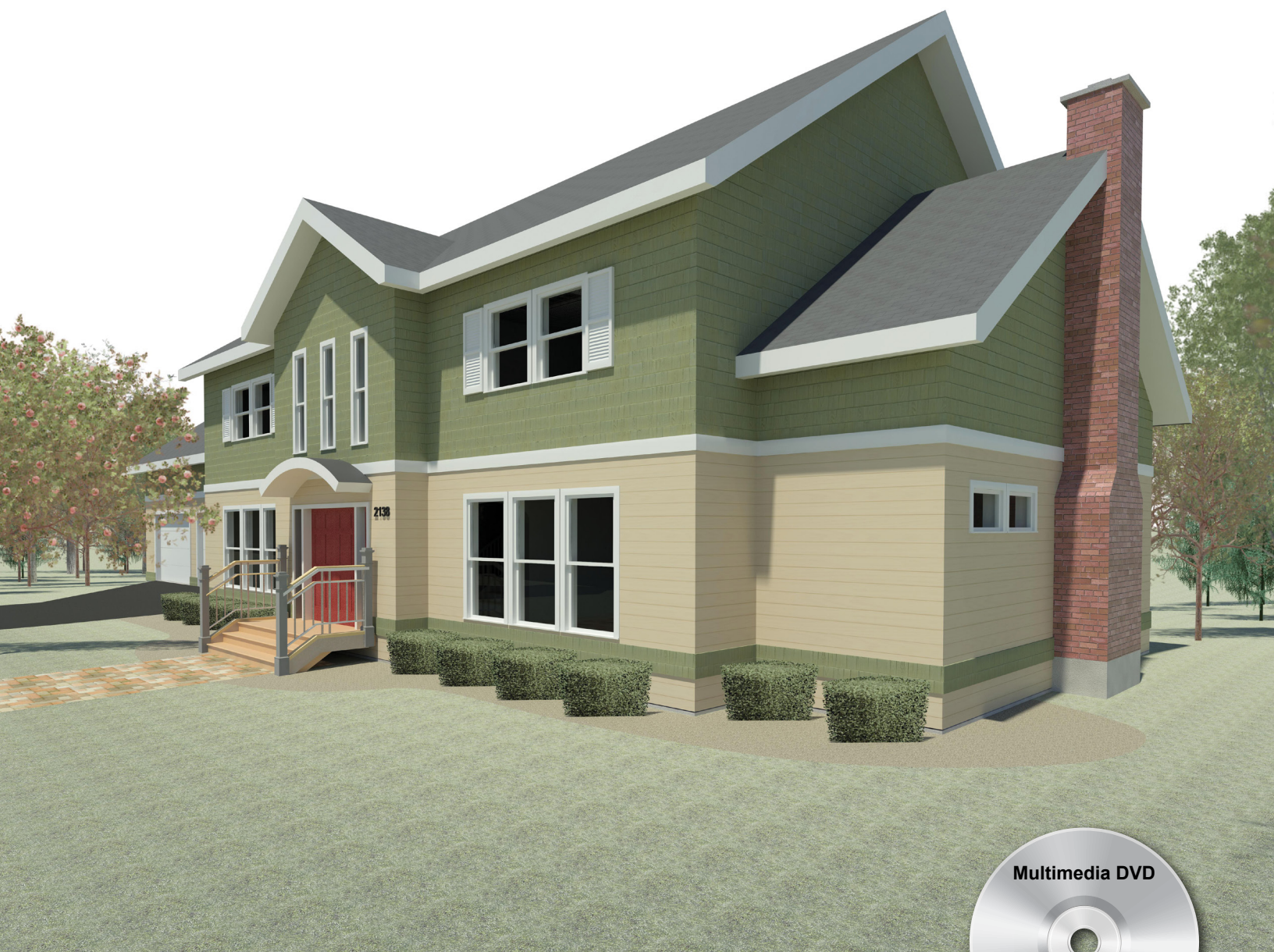

Visit the following websites to learn more about this book:



[amazon.com](https://www.amazon.com)

[BARNES & NOBLE](https://www.barnesandnoble.com)

[Google books](https://books.google.com)

TABLE OF CONTENTS

	Page
INTRODUCTION – Sketching Exercises	
I-1 Introduction	I-1
I-2 Freehand sketching from photos	I-7
I-3 Surveying and Sketching Objects	I-19
I-4 Sketching Floor Plans	I-23
I-5 Sketching Elevations – two point perspective	I-29
I-6 Sketching Elevations – one point perspective	I-41
I-7 Sketching Plans – one point perspective	I-49
1. Getting Started with Autodesk® Revit® Architecture 2013	
1-1 What is Revit Architecture 2013?	1-1
1-2 Overview of the Revit User Interface	1-10
1-3 Open, Save and Close an Existing Project	1-21
1-4 Creating a New Project	1-26
1-5 Using Pan and Zoom to View Your Drawings	1-28
1-6 Using Revit's Help System	1-33
<i>Self-Exam and Review Questions</i>	
2. Lake Cabin: FLOOR PLAN (The Basics)	
2-1 Walls	2-1
2-2 Doors	2-5
2-3 Windows	2-7
2-4 Roof	2-9
2-5 Annotation and Dimensions	2-11
2-6 Printing	2-15
<i>Self-Exam and Review Questions</i>	
3. Overview of Linework and Modify Tools	
3-1 Lines and Shapes	3-1
3-2 Snaps	3-15
3-3 Edit Tools	3-20
3-4 Annotations	3-33
<i>Self-Exam and Review Questions</i>	
4. Drawing 2D Architectural Objects	
4-1 Sketching Rectilinear Objects	4-1
4-2 Sketching Objects with Curves	4-11
<i>Self-Exam and Review Questions</i>	
5. Residence: FLOOR PLAN (First Floor)	
5-1 Project Setup	5-1
5-2 Exterior Walls	5-7
5-3 Interior Walls	5-23
5-4 Doors Openings and Windows	5-35
5-5 Adding a Fireplace	5-54
<i>Self-Exam and Review Questions</i>	
6. Residence: FLOOR PLANS (Second Floor and Basement Plans)	
6-1 View Setup and Enclosing the Shell	6-1
6-2 Adding the Interior Walls	6-6
6-3 Adding Doors, Openings and Windows	6-10
6-4 Basement Floor Plan	6-15
6-5 Stairs	6-22
6-6 Dimensions	6-35
<i>Self-Exam and Review Questions</i>	

	Page
7. Residence: ROOF	
7-1 Roof Design Options	7-1
7-2 Gable Roof	7-11
7-3 Low Roof Elements	7-19
7-4 Skylights	7-30
<i>Self-Exam and Review Questions</i>	
8. Residence: FLOOR SYSTEMS AND REFLECTED CEILING PLANS	
8-1 Floor Systems	8-1
8-2 Ceiling Systems (Susp. ACT and Gypsum Board)	8-16
8-3 Placing Light Fixtures	8-31
8-4 Annotations	8-36
<i>Self-Exam and Review Questions</i>	
9. Residence: ELEVATIONS	
9-1 Creating and Viewing Exterior Elevations	9-1
9-2 Modifying the Project Model: Exterior Elevations	9-9
9-3 Creating and Viewing Interior Elevations	9-16
9-4 Modifying the Project Model: Interior Elevations	9-22
9-5 Design Options	9-25
<i>Self-Exam and Review Questions</i>	
10. Residence: SECTIONS	
10-1 Specify Section Cutting Plane in Plan View	10-1
10-2 Modifying the Project Model in Section View	10-7
10-3 Wall Sections	10-15
10-4 Annotations and Detail Components	10-25
<i>Self-Exam and Review Questions</i>	
11. Residence: INTERIOR DESIGN	
11-1 Bathroom Layouts	11-1
11-2 Kitchen Layout	11-7
11-3 Furniture	11-20
11-4 Adding Guardrails	11-25
<i>Self-Exam and Review Questions</i>	
12. Residence: SCHEDULES	
12-1 Room and Door Tags	12-1
12-2 Generate a Door Schedule	12-6
12-3 Generate a Room Finish Schedule	12-10
<i>Self-Exam and Review Questions</i>	
13. Residence: PHOTO-REALISTIC RENDERING	
13-1 Creating an Exterior Rendering	13-1
13-2 Rendering an Isometric in Section	13-14
13-3 Creating an Interior Rendering	13-21
13-4 Adding People to the Rendering	13-27
<i>Self-Exam and Review Questions</i>	
14. Residence: CONSTRUCTION DOCUMENTS SET	
14-1 Setting Up a Sheet	14-1
14-2 Sheet Index	14-10
14-3 Printing a Set of Drawings	14-17
<i>Self-Exam and Review Questions</i>	

Appendix A – Engineering Graphics

Appendix B – Autodesk Revit Architecture Certification Exam, Introduction and sample test

DVD CONTENT

- 15. INTRODUCTION TO SITE DESIGN** - 14 pages
 15-1 Site Tools
- 16. INTRODUCTION TO REVIT CONTENT CREATION** - 67 pages
 16-1 Basic Family Concepts
 16-2 The Box: Creating the Geometry
 16-3 The Box: Adding Parameters
 16-4 The Box: Formulas and Materials
 16-5 The Box: Family Types and Categories
Self-Exam & Review Questions
- 17. INTRODUCTION TO COMPUTERS** - 50 pages
 17-1 Computer Basics: Terms and Functions
 17-2 Overview of the Windows User Interface
 17-3 File Management Introduction
Self-Exam & Review Questions
- 18. INTRODUCTION TO SKETCHUP** - 78 pages
 18-1 What is Google SketchUp used for?
 18-2 Overview of the SketchUp User Interface
 18-3 Open, Save and Close
 18-4 Viewing SketchUp Models
 18-5 Help System
 18-6 The Basic Entities
 18-7 Beginning with the Basics – 2D Sketching
 18-8 3D Modeling
 18-9 Adding Materials
- Appendix C – ROOF STUDY WORKBOOK – DRAFT EDITION** - 90 pages
- Appendix D – FINDING MISSING ELEMENTS IN REVIT** - 24 pages

Videos

- 1. User Interface**
- 2. Walls**
- 3. Doors and Windows**
- 4. Stairs**
- 5. Roofs**
- 6. Floors**
- 7. Ceilings**
- 8. Elevations**
- 9. Sections**
- 10. Schedules**
- 11. Rendering**
- 12. Design Options**
- 13. Sheets and Sheet Lists**
- 14. Worksharing Introduction**
- 15. Phases**
- 16. Sweeps and Reveals**