

Includes
Practice Exam Software

Autodesk® Revit® for Architecture Certified User Exam Preparation

Revit® 2021 Edition

Focused Review for a Successful Exam

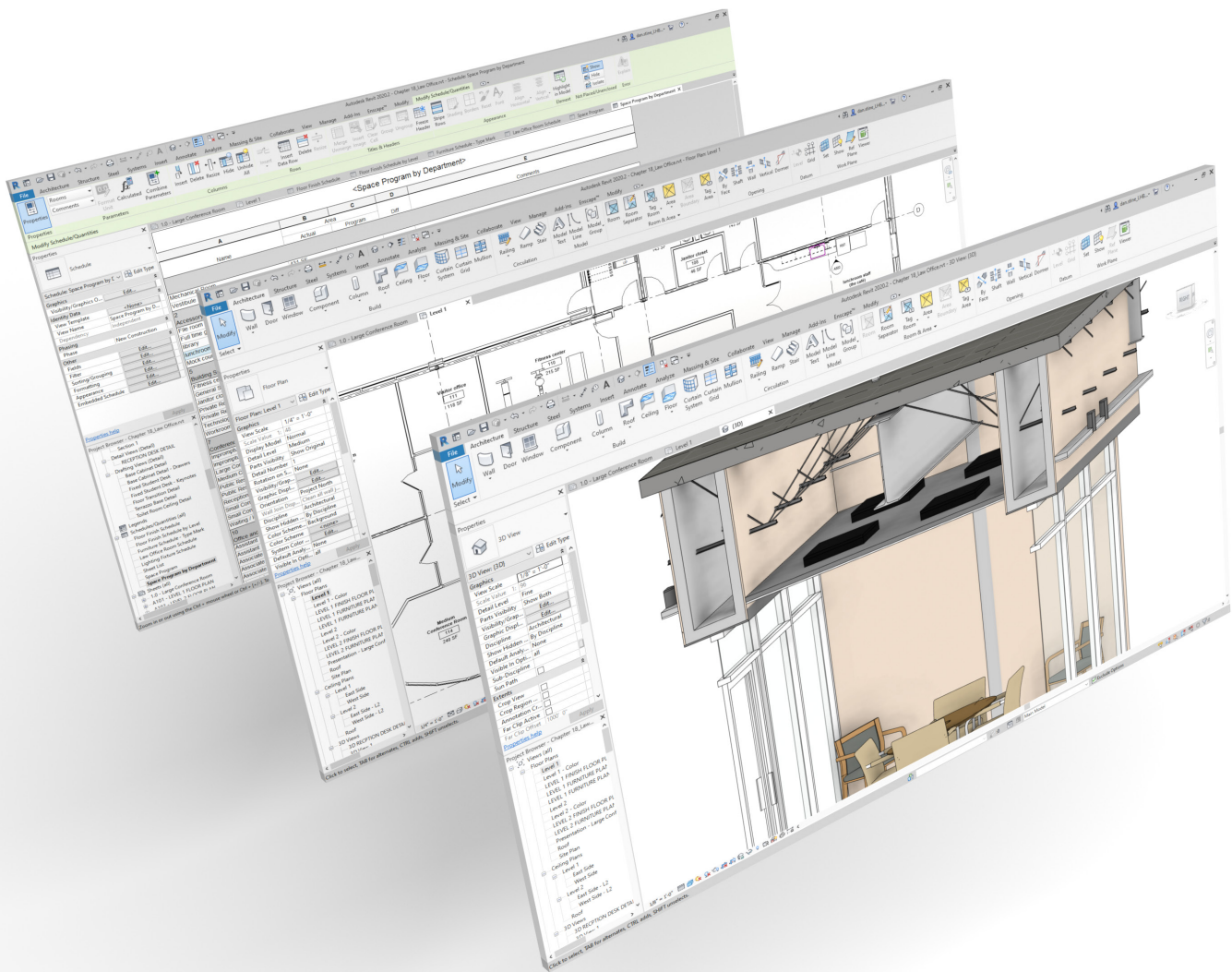

Daniel John Stine AIA, CSI, CDT



Better Textbooks. Lower Prices.
www.SDCpublications.com



ACCESS CODE
UNIQUE CODE INSIDE

Visit the following websites to learn more about this book:



[amazon.com](https://www.amazon.com)

[Google books](https://books.google.com)

[BARNES & NOBLE](https://www.barnesandnoble.com)

Table of Contents

Foreword

1.0 Introduction

| | |
|--|----|
| Overview & Things to know | 2 |
| Benefits (certificate and badging) | 3 |
| Certified User versus Certified Professional | 4 |
| Exam Topics and Objectives | 5 |
| Exam Releases (including languages) | 6 |
| Practice Test | 7 |
| Exam Preparation, During the Exam & Exam Results | 9 |
| Retaking the Exam & Resources | 10 |
| Certiport User Registration | 11 |

2.0 Revit Fundamentals

| | |
|---------------------------------|----|
| Autodesk Revit, Defined | 14 |
| Trial Software | 16 |
| Student Software | 17 |
| File Types and their Extensions | 19 |
| Model Elements | 20 |
| Datum Elements | 21 |
| View Specific Elements | 22 |
| Views, Plans & Elevations | 23 |
| Sections & 3D and Camera | 24 |
| Schedules | 25 |
| Sheets | 26 |

3.0 User Interface Review

| | |
|---|----|
| User Interface Diagram | 28 |
| Application Title Bar & File Tab | 29 |
| Quick Access Toolbar | 30 |
| Architecture & Annotate Tabs | 31 |
| Modify & View Tabs | 32 |
| Modify Contextual Tab | 33 |
| Ribbon States | 34 |
| Options Bar & Properties Palette | 35 |
| Project Browser | 36 |
| View Tabs | 37 |
| Status Bar & Escape Key | 38 |
| View Control Bar, Context Menu, Canvas & Elevation Marker | 39 |

4.0 Elements and Families

| | |
|---------------------------|----|
| Use Grids | 42 |
| Create and Modify Walls | 43 |
| Create and Modify Doors | 45 |
| Create and Modify Windows | 46 |
| Tag Elements by Category | 47 |
| Add and Modify Components | 49 |
| Trim and Extend Elements | 50 |
| Hide and Reveal Elements | 52 |

| | |
|--|-----|
| 5.0 Modeling | |
| Create a Roof and Modify Roof Properties | 56 |
| Create a Stair with a Landing | 58 |
| Create and Modify Railings | 61 |
| Add and Modify Floors | 64 |
| Add Rooms | 66 |
| Move and Copy Elements | 68 |
| Align Elements | 69 |
| Mirror Elements | 71 |
| Array Elements | 73 |
| 6.0 Views | |
| Change the View Scale | 76 |
| Change the Detail Level of a View | 77 |
| Set Visibility/Graphics Overrides | 78 |
| Identify the Cut Plane for a View | 80 |
| Use Levels | 81 |
| Create Plan Views | 82 |
| Create Elevations and Section Views | 83 |
| Create 3D Views | 85 |
| Create Drafting Views | 86 |
| 7.0 Documentation | |
| Add and Modify Text | 88 |
| Add and Modify Dimensions | 89 |
| Create a Sheet | 91 |
| Place Views on a Sheet | 92 |
| 8.0 Practice Test | |
| Instructions and start | 94 |
| 9.0 Practice Test Answers | |
| Answers | 100 |
| 10.0 Practice Exam | |
| Introduction | 104 |

Index

Downloads:

- **Practice Test Software**
See inside-front cover for download instructions and your unique access code
- **Practice Exam Software**
See inside-front cover for download instructions and your unique access code