

Daniel John Stine  
AIA, IES, CSI, CDT, Well AP

# Interior Design Using Autodesk® Revit® 2025

Introduction to Building Information Modeling for Interior Designers



Better Textbooks. Lower Prices.  
[www.SDCpublications.com](http://www.SDCpublications.com)



**ACCESS CODE**  
UNIQUE CODE INSIDE

Visit the following websites to learn more about this book:



[amazon.com](https://www.amazon.com)

[Google books](https://books.google.com)

[BARNES & NOBLE](https://www.barnesandnoble.com)

## Table of Contents

<b>1.</b>	<b>Getting Started with Autodesk Revit 2025</b>	
1-1	What is Revit 2025?	1-1
1-2	Overview of the Revit User Interface	1-11
1-3	Open, Save and Close a Revit Project	1-26
1-4	Creating a New Project	1-31
1-5	Using Revit's Help System	1-33
1-6	Introduction to Autodesk Drive	1-36
	<i>Self-Exam &amp; Review Questions</i>	1-42
<b>2.</b>	<b>Model Navigation</b>	
2-1	Using Zoom and Pan to View Your Drawings	2-1
2-2	Creating 2D Sections	2-6
2-3	Navigating the 3D Model	2-15
	<i>Self-Exam &amp; Review Questions</i>	2-26
<b>3.</b>	<b>Quick Start: Small Office</b>	
3-1	Walls, Grids and Dimensions	3-1
3-2	Doors	3-18
3-3	Windows	3-25
3-4	Roof	3-28
3-5	Annotation, Room Tags & Schedules	3-33
3-6	Printing	3-38
	<i>Self-Exam &amp; Review Questions</i>	3-41
<b>4.</b>	<b>Revit Materials</b>	
4-1	Introduction to Using Materials in Revit	4-1
4-2	A Detailed Look at Revit Materials	4-8
4-3	Revit Materials Concepts Applied – Part 1	4-22
4-4	Revit Materials Concepts Applied – Part 2	4-35
4-5	Revit Materials and Custom Parameters	4-48
	<i>Self-Exam &amp; Review Questions</i>	4-50
<b>5.</b>	<b>Programming</b>	
5-1	Introduction to Schedules	5-1
5-2	Law Office Space Program	5-17
5-3	Developing Bubble Diagrams	5-32
	<i>Self-Exam &amp; Review Questions</i>	5-37
<b>6.</b>	<b>Floor Plans</b>	
6-1	Walls	6-1
6-2	Rooms	6-17
6-3	Floor Plan Development	6-25
6-4	Placing Room Elements in the Model	6-40
	<i>Self-Exam &amp; Review Questions</i>	6-49
<b>7.</b>	<b>Curtain Wall</b>	
7-1	Curtain Wall	7-1
7-2	Developing the Interior Fenestrations	7-10
	<i>Self-Exam &amp; Review Questions</i>	7-28
<b>8.</b>	<b>Stairs and Railings</b>	
8-1	Introduction to Stairs	8-1
8-2	Introduction to Railings	8-14
8-3	Modeling the Stairs	8-38
	<i>Self-Exam &amp; Review Questions</i>	8-54
<b>9.</b>	<b>Ceilings</b>	
9-1	Introduction to Revit Ceilings	9-2
9-2	Modeling Ceilings	9-11
	<i>Self-Exam &amp; Review Questions</i>	9-41
<b>10.</b>	<b>Break Room and Work Room</b>	
10-1	Tagging	10-1
10-2	Shared Parameters	10-9
10-3	Casework Content	10-16

10-4	Work Room	10-23
10-5	Lunch Room	10-37
	<i>Self-Exam &amp; Review Questions</i>	10-51
<b>11.</b>	<b>Toilet Room Design</b>	
11-1	Toilet Room Layout Introduction	11-1
11-2	Toilet Room Layout	11-6
11-3	Toilet Room Wall Finishes	11-21
11-4	Level 2 Private Toilet Rooms	11-33
	<i>Self-Exam &amp; Review Questions</i>	11-34
<b>12.</b>	<b>Floors</b>	
12-1	Introduction to Revit Floors	12-1
12-2	Modeling Floor Finishes – Carpet	12-14
12-3	Modeling Floor Finishes – Ceramic Tile, Sheet Goods, Etc.	12-32
	<i>Self-Exam &amp; Review Questions</i>	12-38
<b>13.</b>	<b>Custom Reception Desk and Sign</b>	
13-1	Creating a Custom Reception Desk	13-2
13-2	Lobby Wall Sign	13-17
13-3	Controlling the Graphical Representation of Elements	13-23
	<i>Self-Exam &amp; Review Questions</i>	13-31
<b>14.</b>	<b>Furniture, Groups and Design Options</b>	
14-1	Furniture Content	14-1
14-2	Furniture Placement	14-6
14-3	Design Options	14-29
	<i>Self-Exam &amp; Review Questions</i>	14-38
<b>15.</b>	<b>Detailing</b>	
15-1	Introduction to Detailing	15-1
15-2	Exercises	15-2
15-3	Live Detail – Reception Desk	15-27
	<i>Self-Exam &amp; Review Questions</i>	15-30
<b>16.</b>	<b>Schedules</b>	
16-1	Room Finish Schedule	16-1
16-2	Furniture Schedule	16-12
16-3	Floor Finish Schedule	16-18
	<i>Self-Exam &amp; Review Questions</i>	16-24
<b>17.</b>	<b>Lighting and Rendering</b>	
17-1	Lighting Design	17-2
17-2	Creating a Rendering of the Lobby	17-12
17-3	Rendering an Isometric in Section	17-19
17-4	Creating another Interior Rendering	17-23
17-5	Adding People to the Rendering	17-28
17-6	Rendering Tips and Tricks	17-33
	<i>Self-Exam &amp; Review Questions</i>	17-46
<b>18.</b>	<b>Sheets and Revisions</b>	
18-1	Creating Sheets	18-1
18-2	Creating a Sheet Index	18-10
18-3	Presentation Boards	18-14
18-4	Printing a Set of Drawings	18-20
18-5	Managing Construction Phase Revisions	18-27
	<i>Self-Exam &amp; Review Questions</i>	18-37
<b>Index</b>		Index-1

## Exclusive Online Content

See the inside-front cover of this book for download instructions and your unique access code.

### Bonus Chapters

<b>19.</b>	<b>Introduction to Phasing and Worksharing</b>	
19-1	Introduction to Phasing	19-1
19-2	Introduction to Worksharing	19-10
19-3	Phasing Exercise	19-23
19-4	Worksharing Exercise	19-35
	<i>Self-Exam &amp; Review Questions</i>	19-46
<b>20.</b>	<b>Introduction to Revit Content Creation</b>	
20-1	Basic Family Concepts	20-1
20-2	The Box: Creating the Geometry	20-13
20-3	The Box: Adding Parameters	20-29
20-4	The Box: Formulas and Materials	20-45
20-5	The Box: Family Types and Categories	20-59
	<i>Self-Exam &amp; Review Questions</i>	20-66
Appendix A:	<b>Autodesk Revit Certification Exam Introduction</b>	
Appendix B:	<b>Revit Basics: Overview of Linework and Modify Tools</b> 38 pages	
B-1	Lines and Shapes	B-1
B-2	Snaps	B-15
B-3	Modify Tools	B-20
B-4	Annotations	B-33
	<i>Self-Exam &amp; Review Questions</i>	B-37
Appendix C:	<b>Revit Basics: Drawing 2D Architectural Content</b> 30 pages	
C-1	Sketching Rectilinear Objects	C-1
C-2	Sketching Objects With Curves	C-11
	<i>Self-Exam &amp; Review Questions</i>	C-29
Appendix D:	<b>Finding Missing Elements in Revit</b> 21 pages	D-1
Appendix E:	<b>Introduction to Computers for CAD/BIM Users</b> 48 pages	
E-1	Computer Basics: Terms and Functions	E-1
E-2	Overview of the Windows User Interface	E-18
E-3	File Management Introduction	E-38
	<i>Self-Exam &amp; Review Questions</i>	E-48
Appendix F:	<b>Revit and 3D PDFs</b> 11 pages	
Appendix G:	<b>Lighting Design in Revit using ElumTools</b> 46 pages	
Appendix H:	<b>Building Performance Analysis</b> 35 pages	
Appendix M	<b>Introduction to Multi-Story Stairs</b>	

### Bonus Videos

This book comes with several short videos, approximately 3-5 minutes long, which can be watched in order while working through this book. The full index of video titles can be found on the next page.

These videos are supplementary and not required to complete the exercises in this book. Rather, the videos are intended to cover many of the fundamental Revit topics in a different context to help the reader better understand this important material. A few videos cover intermediate topics, such as the sloped “cloud” ceiling shown in the image to the right.

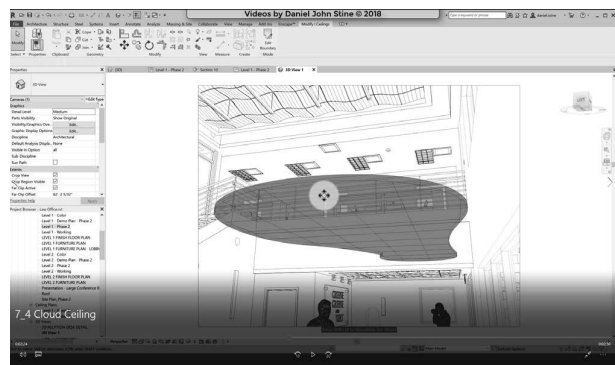

## Bonus Videos Index:

- |  |  |
|--|--|
| <p><b>1 User Interface</b></p> <ul style="list-style-type: none"> <li>1-1 Introduction</li> <li>1-2 File Tab</li> <li>1-3 Ribbon and QAT</li> <li>1-4 Properties and Type Selector</li> </ul> <p><b>2 Walls</b></p> <ul style="list-style-type: none"> <li>2-1 Introduction</li> <li>2-2 Wall Types</li> <li>2-3 Wall Placement Settings</li> <li>2-4 Wall Height</li> <li>2-5 Creating New Wall Types</li> <li>2-6 Sloped Walls</li> </ul> <p><b>3 Doors and Windows</b></p> <ul style="list-style-type: none"> <li>3-1 Introduction</li> <li>3-2 Placing Doors</li> <li>3-3 Placing Windows</li> <li>3-4 Managing Loaded Content</li> <li>3-5 Repositioning Doors and Windows</li> <li>3-6 Curtainwall Introduction</li> </ul> <p><b>4 Stairs</b></p> <ul style="list-style-type: none"> <li>4-1 Introduction</li> <li>4-2 Stair Placement Settings</li> <li>4-3 Curved Landing</li> <li>4-4 Railings</li> </ul> <p><b>5 Roofs</b></p> <ul style="list-style-type: none"> <li>5-1 Introduction</li> <li>5-2 Hip Roof</li> <li>5-3 Gable Roof</li> <li>5-4 Shed Roof</li> <li>5-5 Flat Roof</li> <li>5-6 Roof Fascia</li> <li>5-7 Roof Gutters</li> <li>5-8 Roof Openings</li> </ul> <p><b>6 Floors</b></p> <ul style="list-style-type: none"> <li>6-1 Introduction</li> <li>6-2 Floor Placement Settings</li> <li>6-3 Floor Openings</li> <li>6-4 Sloped Floor</li> </ul> <p><b>7 Ceilings</b></p> <ul style="list-style-type: none"> <li>7-1 Introduction</li> <li>7-2 Ceiling Placement Settings</li> <li>7-3 Sloped Ceiling</li> <li>7-4 Cloud Ceiling</li> </ul> <p><b>8 Elevations</b></p> <ul style="list-style-type: none"> <li>8-1 Introduction</li> <li>8-2 Exterior Elevations</li> <li>8-3 Interior Elevations</li> </ul> | <ul style="list-style-type: none"> <li>8-4 Elevation VG Settings</li> <li>8-5 Depth Cueing in Elevations</li> <li>8-6 Edit Plan Symbol</li> </ul> <p><b>9 Sections</b></p> <ul style="list-style-type: none"> <li>9-1 Introduction</li> <li>9-2 Building Sections</li> <li>9-3 Wall Sections</li> <li>9-4 Sections VG Settings</li> </ul> <p><b>10 Schedules</b></p> <ul style="list-style-type: none"> <li>10-1 Introduction</li> <li>10-2 Room Schedules</li> <li>10-3 Door Schedules</li> </ul> <p><b>11 Rendering</b></p> <ul style="list-style-type: none"> <li>11-1 Introduction</li> <li>11-2 Exterior Rendering</li> <li>11-3 Interior Rendering</li> <li>11-4 Materials</li> <li>11-5 Lighting</li> </ul> <p><b>12 Design Options</b></p> <ul style="list-style-type: none"> <li>12-1 Introduction</li> <li>12-2 Design Options Setup</li> <li>12-3 Adding Elevations to Design Options</li> <li>12-4 Removing Design Options</li> </ul> <p><b>13 Sheets and Sheet Lists</b></p> <ul style="list-style-type: none"> <li>13-1 Introduction</li> <li>13-2 Creating Sheets</li> <li>13-3 Placing Views on Sheets</li> <li>13-4 Placing Schedules on Sheets</li> </ul> <p><b>14 Worksharing Introduction</b></p> <ul style="list-style-type: none"> <li>14-1 Introduction</li> <li>14-2 Worksharing Project Setup</li> <li>14-3 Creating a Local File</li> <li>14-4 Troubleshooting</li> </ul> <p><b>15 Phasing</b></p> <ul style="list-style-type: none"> <li>15-1 Introduction</li> <li>15-2 Phase Project Setup</li> <li>15-3 Phasing View Settings</li> <li>15-4 Phasing Element Settings</li> </ul> <p><b>16 Sweeps and Reveals</b></p> <ul style="list-style-type: none"> <li>16-1 Sweeps</li> <li>16-2 Reveals</li> <li>16-3 New Profiles</li> </ul> |
|--|--|