

Autodesk®

Revit® 2025 Architecture Fundamentals

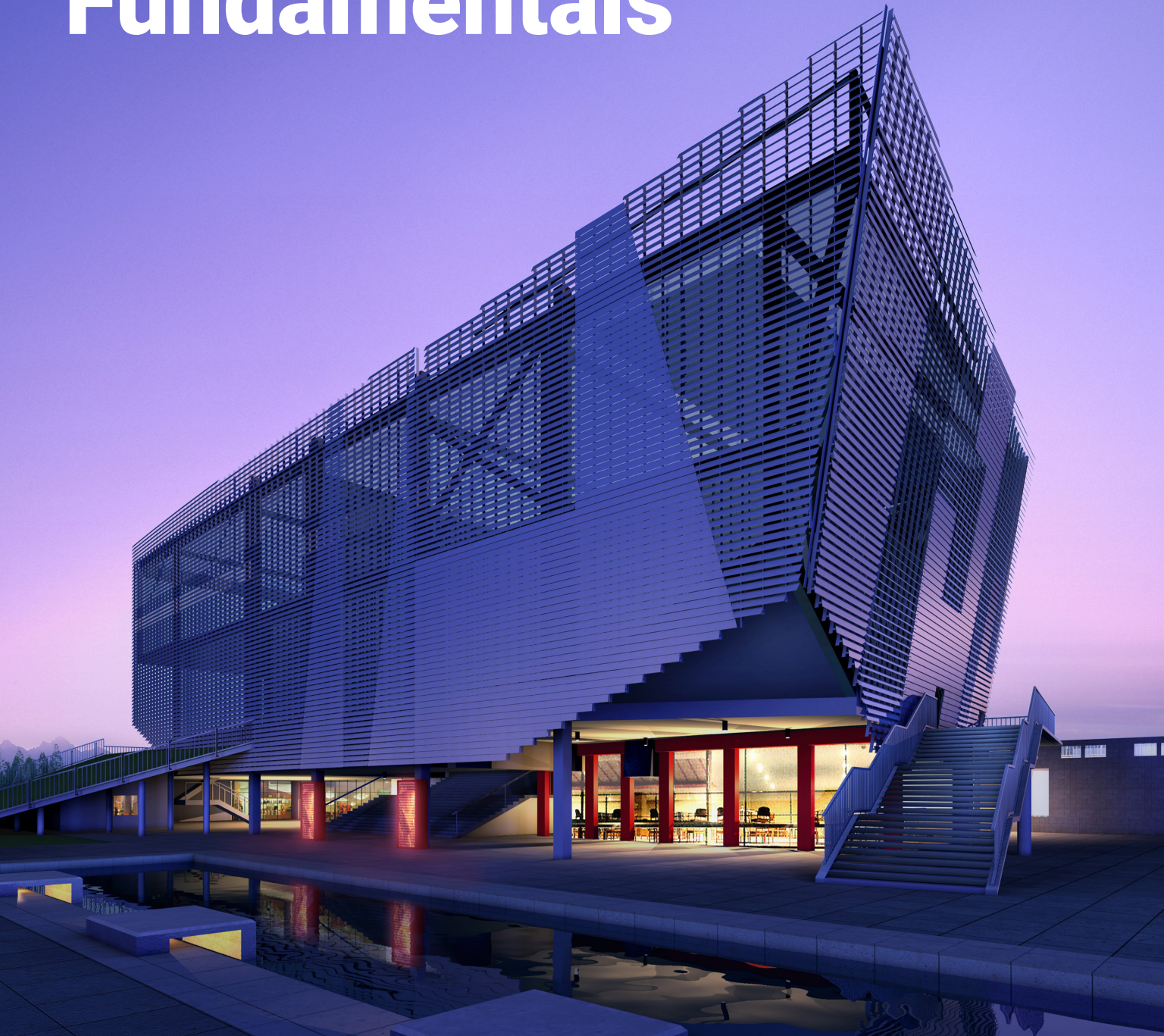

Better Textbooks. Lower Prices.
www.SDCpublications.com

Visit the following websites to learn more about this book:



Contents

Preface	xi
In This Guide	xiii
Practice Files	xv

Introduction to Autodesk Revit and Project Setup

Chapter 1: Introduction to Revit	1-1
1.1 BIM and Revit	1-2
Workflow and BIM	1-3
Revit Terms	1-4
Revit and Construction Documents	1-5
1.2 Overview of the Interface	1-6
1.3 Opening and Saving Projects	1-28
Opening Projects	1-29
Saving Projects	1-30
1.4 Viewing Commands	1-32
Zooming and Panning	1-32
Viewing in 3D	1-34
ViewCube	1-39
Visual Styles	1-41
Select and Identify Elements in a Project	1-43
Practice 1a: Open and Review a Project	1-44
Chapter Review Questions	1-52
Command Summary	1-54

Chapter 2: Starting a Revit Project	2-1
2.1 Selecting a Project Template	2-2
2.2 Linking and Importing Files	2-4

2.3	Linking in Revit Models	2-8
2.4	Modifying Imported/Linked Files	2-10
	Managing Links	2-14
	Practice 2a: Start a Project and Link Files	2-16
2.5	Setting Up Levels	2-20
	Modifying Levels	2-22
	Creating Plan Views	2-25
	Practice 2b: Set Up Levels	2-27
2.6	Creating Grids	2-33
	Modifying Grid Lines	2-36
	Practice 2c: Add Grids	2-39
	Chapter Review Questions	2-42
	Command Summary	2-44
Chapter 3: Working with Views		3-1
3.1	Understanding the Project Browser	3-2
3.2	Duplicating Views	3-5
3.3	Modify How the View Displays	3-8
	View Control Bar.....	3-8
	View Properties	3-9
	Hiding and Overriding Graphics.....	3-12
	Visibility/Graphic Overrides	3-14
	Working with Crop Regions	3-17
	Plan Regions	3-18
	View Templates.....	3-20
	Practice 3a: Duplicate Views and Set the View Display	3-22
3.4	Adding Callout Views	3-24
	Practice 3b: Add Callout Views	3-27
3.5	Creating Elevations and Sections	3-32
	Elevations.....	3-33
	Sections	3-34
	Modifying Elevations and Sections	3-35
	3D Section Views.....	3-39
	Practice 3c: Create Elevations and Sections	3-42
	Chapter Review Questions	3-50
	Command Summary	3-53

Chapter 4: Revit Families	4-1
4.1 About Revit Families	4-2
Working with Component Families	4-6
4.2 Loading Components	4-7
Placing Components.....	4-10
Using Snaps	4-11
Snap Overrides	4-12
Snaps Settings.....	4-13
4.3 Modifying Components	4-14
4.4 Creating Additional Family Types in a Project	4-17
Families with Connectors	4-19
Practice 4a: Load Components	4-21
Chapter Review Questions	4-28
Command Summary	4-30
Chapter 5: Basic Sketching and Modify Tools	5-1
5.1 Adding General Building Elements	5-2
Draw Tools.....	5-4
Drawing Aids.....	5-6
Reference Planes	5-8
Editing Building Elements	5-10
Selecting Multiple Elements	5-12
Measuring Tool.....	5-14
Filtering Selection of Multiple Elements	5-15
Practice 5a: Sketch and Edit Elements	5-17
5.2 Working with Basic Modify Tools	5-22
Moving and Copying Elements.....	5-22
Rotating Elements.....	5-24
Mirroring Elements.....	5-25
Creating Linear and Radial Arrays.....	5-26
Aligning Elements.....	5-30
Practice 5b: Work with Basic Modify Tools	5-32
5.3 Working with Additional Modify Tools	5-41
Splitting Linear Elements	5-41
Trimming and Extending.....	5-42
Offsetting Elements	5-44
Practice 5c: Work with Additional Modify Tools	5-46
Chapter Review Questions	5-50
Command Summary	5-54

Design Development

Chapter 6: Adding Columns	6-1
6.1 Adding Columns	6-2
Modifying Columns	6-5
6.2 Adding Isolated Footings	6-7
Practice 6a: Add Columns	6-9
Chapter Review Questions	6-15
Command Summary.....	6-16
Chapter 7: Modeling Walls	7-1
7.1 Modeling Walls	7-2
7.2 Modifying Walls	7-11
Wall Joins	7-14
Editing Wall Joins	7-15
Editing Wall Profiles	7-17
Wall Openings.....	7-18
7.3 Adding Wall Footings	7-21
Practice 7a: Model the Exterior Shell.....	7-25
Practice 7b: Add Interior Walls	7-30
Practice 7c: Model Additional Walls	7-45
7.4 Adding Room Elements.....	7-52
Practice 7d: Add Room Elements	7-57
Chapter Review Questions	7-65
Command Summary.....	7-68
Chapter 8: Working with Doors and Windows	8-1
8.1 About Doors and Windows	8-2
8.2 Creating Additional Door and Window Sizes	8-7
Practice 8a: Add Doors and Windows	8-8
Chapter Review Questions	8-18
Command Summary.....	8-20

Chapter 9: Working with Curtain Walls		9-1
9.1	Creating Curtain Walls	9-2
9.2	Adding Curtain Wall Grids	9-6
	Modifying Curtain Wall Grids	9-7
	Practice 9a: Work with Curtain Walls	9-10
9.3	Working with Curtain Wall Panels.....	9-16
	Creating a Curtain Wall Panel.....	9-18
9.4	Attaching Mullions to Curtain Wall Grids	9-20
	Modifying Mullions.....	9-21
	Practice 9b: Add Mullions and Panels to Curtain Walls	9-22
	Chapter Review Questions	9-31
	Command Summary.....	9-33
Chapter 10: Modeling Floors		10-1
10.1	Modeling Floors	10-2
	Modifying Floors.....	10-6
	Joining Geometry	10-7
	Practice 10a: Model Floors.....	10-9
10.2	Creating Shaft Openings	10-17
10.3	Creating Sloped Floors.....	10-18
	Creating Multiple Slopes for Drainage	10-19
	Practice 10b: Create Shaft Openings and Sloped Floors	10-23
10.4	Creating Floor Types.....	10-28
	Chapter Review Questions	10-33
	Command Summary.....	10-35
Chapter 11: Modeling Ceilings		11-1
11.1	Modeling Ceilings	11-2
	Sketching Ceilings.....	11-4
	Modifying Ceiling Grids.....	11-5
11.2	Adding Ceiling Fixtures	11-7
	Practice 11a: Model Ceilings and Add Ceiling Fixtures	11-10
11.3	Creating Ceiling Soffits	11-16
	Practice 11b: Create Ceiling Soffits.....	11-18
	Chapter Review Questions	11-23
	Command Summary.....	11-26

Chapter 12: Modeling Roofs		12-1
12.1	Modeling Roofs	12-2
	Roof Types	12-3
12.2	Creating Roofs by Footprint	12-6
	Attaching Walls to Roofs	12-8
	Modify the Footprint of a Roof	12-9
	Practice 12a: Create Roofs by Footprint	12-12
12.3	Creating Roofs by Extrusion	12-19
	Modify Extruded Roof	12-24
	Joining Roofs.....	12-26
	Practice 12b: Create Roofs by Extrusion	12-27
	Chapter Review Questions	12-30
	Command Summary	12-32
Chapter 13: Modeling Stairs, Railings, and Ramps		13-1
13.1	Creating Component Stairs	13-2
	Creating Runs	13-3
	Creating Other Types of Runs.....	13-6
	Creating Landings	13-9
	Adding Supports.....	13-10
	Practice 13a: Create Component Stairs	13-11
13.2	Modifying Component Stairs	13-19
	Multistory Stairs	13-22
	Practice 13b: Modify Component Stairs	13-24
13.3	Working with Railings	13-32
	Modifying Railings.....	13-34
	Practice 13c: Work with Railings	13-36
13.4	Creating Ramps	13-45
	Practice 13d: Create Ramps	13-48
	Chapter Review Questions	13-51
	Command Summary	13-53

Construction Documentation

Chapter 14: Creating Construction Documents	14-1
14.1 Setting Up Sheets	14-2
Sheet (Title Block) Properties.....	14-4
14.2 Placing and Modifying Views on Sheets	14-5
Open Sheet.....	14-8
14.3 Swapping Views on a Sheet	14-10
Duplicating Sheets	14-14
Sheet Collections.....	14-16
14.4 Modifying Views and View Titles	14-17
Practice 14a: Set Up Sheets	14-21
14.5 Printing Sheets	14-28
Printing Options.....	14-28
Export Views and Sheets to PDF	14-33
Chapter Review Questions	14-34
Command Summary	14-36
Chapter 15: Working with Annotations	15-1
15.1 Working with Dimensions	15-2
Modifying Dimensions	15-5
Setting Constraints.....	15-10
Practice 15a: Work with Dimensions	15-15
15.2 Working with Text	15-22
Modifying Text.....	15-25
Spell Checking	15-30
Creating Text Types	15-31
Practice 15b: Work with Text	15-33
15.3 Adding Detail Lines and Symbols	15-38
Using Symbols.....	15-39
Practice 15c: Add Detail Lines and Symbols	15-40
15.4 Creating Legends	15-44
Practice 15d: Create Legends	15-47
Chapter Review Questions	15-50
Command Summary	15-53

Chapter 16: Adding Tags and Schedules	16-1
16.1 Adding Tags	16-2
Tagging in 3D Views.....	16-12
Practice 16a: Add Tags	16-14
16.2 Working with Schedules	16-20
Building Component Schedules	16-20
Schedule View Properties.....	16-29
Filtering Elements from Schedules	16-31
Modifying Schedules.....	16-32
Modifying a Schedule on a Sheet.....	16-34
Split a Schedule Across Multiple Sheets	16-35
Filter by Sheet.....	16-36
Practice 16b: Work with Schedules	16-38
Chapter Review Questions	16-45
Command Summary	16-46
Chapter 17: Creating Details	17-1
17.1 Setting Up Detail Views	17-2
Referencing a Drafting View	17-5
Saving Drafting Views	17-6
17.2 Adding Detail Components	17-9
Detail Components.....	17-9
Repeating Details	17-11
17.3 Annotating Details	17-13
Filled Regions	17-13
Adding Detail Tags	17-16
Linework.....	17-17
Practice 17a: Create a Detail Based on a Section Callout	17-18
Practice 17b: Create a Detail in a Drafting View	17-26
Chapter Review Questions	17-30
Command Summary	17-32
Appendix A: Additional Tools for Design Development	A-1
A.1 Displaying Views in the Project Browser	A-2
A.2 Selection Sets	A-5
A.3 Purging Unused Elements	A-8
A.4 Wall Sweeps and Reveals	A-9
A.5 Creating Curtain Wall Types with Automatic Grids	A-12

A.6	Creating Fascias, Soffits, and Gutters	A-15
	Fascias	A-15
	Soffits	A-16
	Gutters	A-17
A.7	Creating Dormers.....	A-18
A.8	Enhancing Views.....	A-21
	Splitting Faces	A-22
	Applying Materials.....	A-23
	Editing Plan and Section Profiles	A-26
A.9	Introduction to Revit Worksharing	A-28
	Worksharing Definitions.....	A-29
	Saving a Workshared Project	A-32
	Command Summary.....	A-35
Appendix B: Additional Tools for Construction Documents		B-1
B.1	Working with Guide Grids on Sheets	B-2
B.2	Revision Tracking	B-4
	Issuing Revisions.....	B-9
B.3	Path of Travel and Route Analysis.....	B-10
B.4	Annotating Dependent Views	B-13
	Annotating Views	B-14
B.5	Material Takeoff Schedules	B-17
B.6	Importing and Exporting Schedules.....	B-18
B.7	Creating a Repeating Detail.....	B-20
B.8	Keynoting and Keynote Legends	B-22
	Keynote Legends.....	B-25
	Command Summary.....	B-27
	Index.....	Index-1